

**TOWN AND COUNTRY PLANNING ACT 1990**

**LONDON BOROUGH OF MERTON**

**REDEVELOPMENT AT EASTFIELDS ESTATE (PHASE 1) AND STOPPING UP  
ORDER NO. 2 2023 NOTICE OF MAKING OF STOPPING UP ORDER SECTION  
247 TOWN AND COUNTRY PLANNING ACT 1990**

NOTICE IS HEREBY GIVEN that on 8<sup>th</sup> June 2023 the Council of the London Borough of Merton, Civic Centre, London Road, Morden, Surrey, SM4 5DX (hereinafter called "the Council") made an order ("the Order") pursuant to section 247 of the Town and Country Planning Act 1990 (hereinafter called "the Act") in respect of:

*The existing highways relating to Eastfields Phase 1 made up of the carriageway and footway areas for Clay Avenue , from Pains Close then moving East up to the area adjacent to Thrupp close on the Eastfields estate in Mitcham comprising of an area of 1639 m<sup>2</sup> as shown on the attached plan ("the Footpaths")*

The effect of the Order is that the Footpaths have ceased to be public highway.

The Council is satisfied that it was necessary to stop up the Footpaths that are subject to this Order to allow for the implementation of the planning permission described in the Schedule.

A copy of the Order and a map defining the land to which it relates can be inspected at Council Offices at Front Reception, Merton Civic Centre London Road Morden Surrey SM4 5DX, from 9.00am to 5.00pm Monday to Thursday and 9.00am to 4.45pm on Friday (excluding bank and public holidays).

**Any person aggrieved by the Order and wishing to question its validity, or any provision contained in the Order, on the grounds that it is not within the powers of the Act or that any procedural requirements of the Act or any regulation made under the Act has not been complied with in relation to the making of the Order may, within 6 weeks up to 21<sup>st</sup> July 2023 apply to the High Court for the suspension or quashing of the Order or of any provision contained in the Order.**

London Borough of Merton  
Civic Centre  
London Road  
Morden  
SM4 5DX  
Ref. CS LEG HB 525/118

## **THE SCHEDULE**

### **Description of Development**

17/P1717

The regeneration of the Eastfields Estate comprising the demolition of all existing buildings and structures; erection of new buildings ranging from 1 to a maximum of 9 storeys providing up to 800 residential units (C3 use class); provision of up to 275 sqm of non-residential floorspace (flexible use classes A1 and/or A2 and/or A3 and/or A4 and/or B1 and/or D1 and/or D2) provision of new public open space and communal amenity spaces including children's play space; new public realm, landscaping works and new lighting; cycle parking spaces (including new visitor cycle parking) and car parking spaces (including within ground level podiums), together with associated highways and utilities works

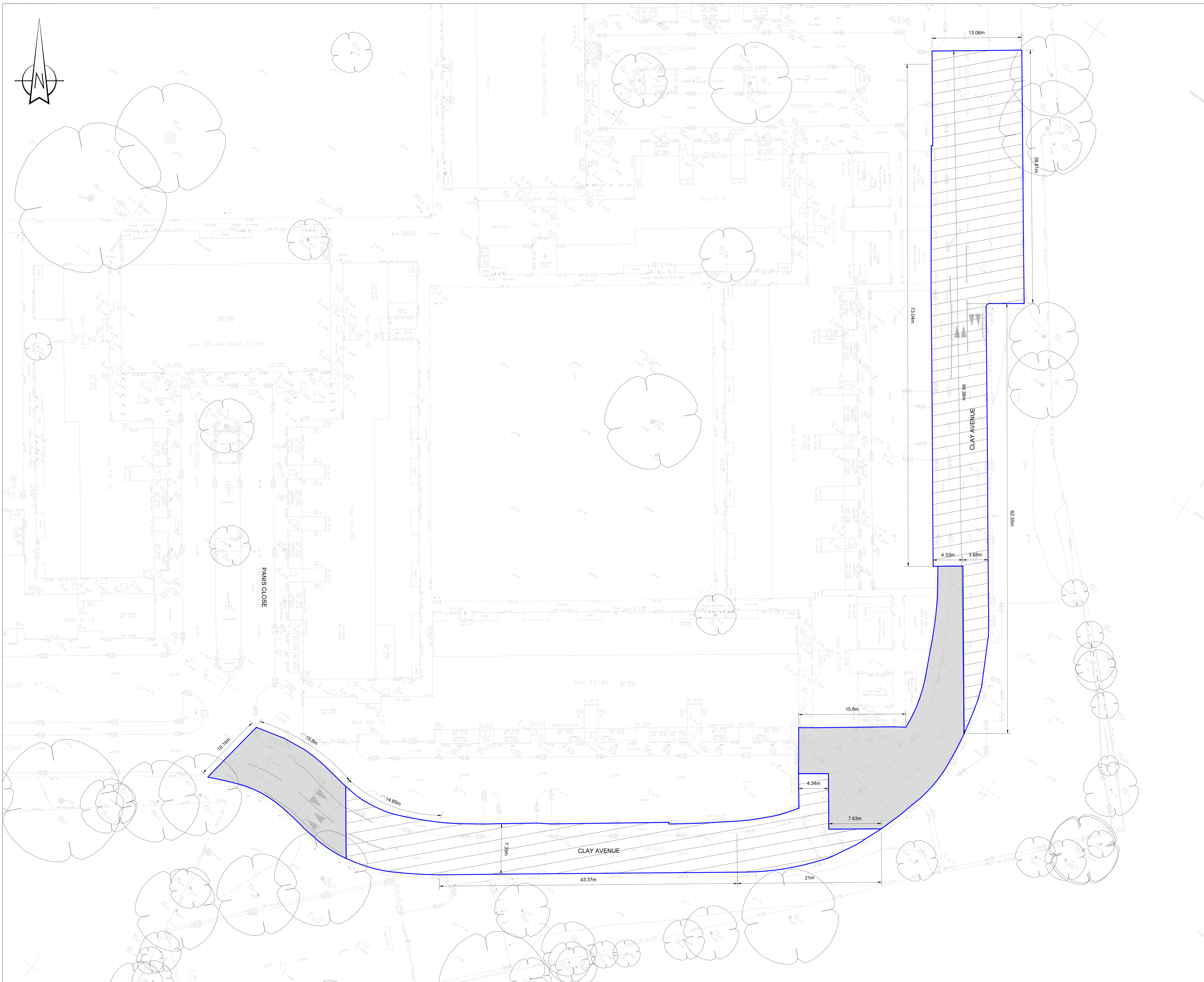

- NOTES:**
- GENERAL**
- Do not scale from drawing.
  - All dimensions are in meters, unless stated otherwise.
  - This drawing to be read & printed in colour.
  - This drawing to be read in conjunction with other contract drawings.
  - Where the contractor undertakes or engages a third party to undertake temporary works design, or varies the Pell Frischmann design in any way, then the contractor will take full responsibility and liability for all design aspects, including a design risk assessment. The contractor shall inform Pell Frischmann of any proposed variances to the design.

- CONSTRUCTION**
- Works shall comply with the current Department of Transport Specification for Highway Works.
  - Filling of voids formed by site clearance operations shall be measured under Series 600 of the Specification.
  - Contractor is to ensure that all voids are to be filled with granular sub base material Type 1.
  - All hard material broken out under the Contract is to be disposed of to contractor's tip.
  - The contractor is to allow in his rates for the disconnection of electrical supplies to all lamp columns, signs, bollards, signals and any other energised furniture.
  - Unless shown otherwise all items of street furniture, covers and frames, trees, bushes, wall etc. are to remain.
  - Re-use of any existing road signs and other street furniture is at the Highway Authority's discretion.
  - Where existing road markings show otherwise than the proposed road markings the contractor shall inform the engineer before removing the road marking.
  - Existing road markings to be removed by an approved contractor.
  - No private areas to drain on to areas already adopted or being offered for adoption and no private surface water drainage to be discharged into any highway gully, highway surface water drain, manhole or soakaway maintained by London Borough of Merton.
  - All works are to comply with the current London Borough of Merton Design Guide and Manual for Street or otherwise agreed with London Borough of Merton.
  - Kerb upstand varies refer to Construction Areas drawings, where varies tie into existing, the difference in upstand is to be adjusted over the last 3.0 full length kerbs (2700mm)
  - Paving pattern shown on drawings for indicative purposes only. Refer to Landscape Architect drawings.
  - Before any construction commences, Contractor to contact London Borough of Merton Clerk of Works to attend all CBR testing of the carriageway.
  - All Proposed Surface Water Drainage to be adopted by Thames Water.

- CDM (RISKS & HAZARDS)**
- Prior to commencement of construction the contractor is to liaise with all relevant statutory undertakers and protect / divert apparatus and to protect the workforce during the works. Any damage caused to the apparatus to be the responsibility of the contractor.
  - Contractor to undertake their own statutory plant checks on site prior to the commencement of excavation exercise.
  - The contractor is to make sure that any excavation should be adequately covered at night to protect both public and wildlife from becoming trapped.
  - Appropriate health and safety measures should be adhered to while working in close proximity to the existing overhead power lines.
  - Contractor to ensure where lamp columns are to remain they are to be made stable during construction.
  - Contractor to allow in his rates for electricity board service connection to proposed signs.

**DISCLAIMERS**

- The information contained in this drawing is based on survey data provided by Aworth drawing 4702 Land Survey and Pell Frischmann shall not be liable for any inaccuracies or deficiencies.

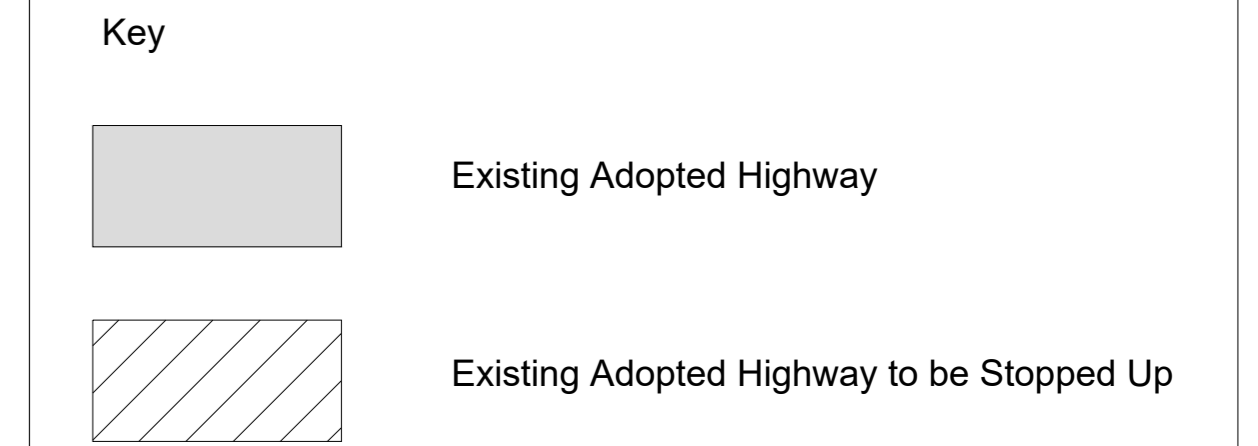

P00	First Issue	KM	TM	TM	17.10.22
REV	DESCRIPTION	DRN	CHK	APP	DATE

**Pell Frischmann**  
 5th Floor, 85 Strand, London WC2R 0DW  
 Telephone +44 (0)20 7486 3661  
 Email: pflondon@pellfrischmann.com  
 www.pellfrischmann.com

**Client**  
 Clarion Housing Group

**Project**  
 Merton  
 Eastfields  
 Phase 1

**Drawing Title**  
 Eastfields Phase 1  
 Highways  
 Stopping Up Plan

	Name	Date	Scale	1:250 @ A1
Drawn	KM	Oct 2022	File No.	DN0073-PEF-XX-XX-DR-D-2001.dwg
Designed	KM	Oct 2022	Drawing Status	Approval
Checked	TM	Oct 2022	Approval	
Approved	TM	Oct 2022	Revision	
Drawing No.	DN0073-PEF-XX-XX-DR-D-2001			P00